

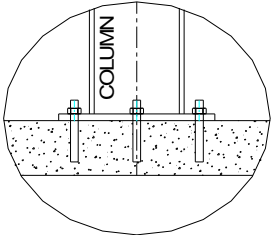

MT. CLEMENS CRANE

42827 Irwin Drive
 Harrison Twp. MI 48045 USA
 P/ 586-468-0909 F/ 586-468-2711
 E/ info@mccrane.com W/ mccrane.com

DIMENSIONS & WEIGHTS - TYPE FSTM-10000
5-TON CAPACITY FREE STANDING RUNWAY
STRUCTURE FOR MOTORIZED CRANE - 25FT TOS



BASE DETAIL

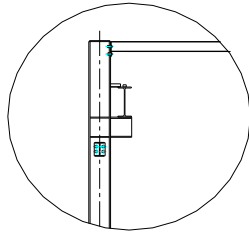

BEAM/COL. DETAIL

GENERAL NOTES:

- Runway rail is rectangular square bar welded to runway beam. Additional field welding is required at splice joints that overlap beam splices.
- Capacities shown are for One (1) Crane at rated capacity.
- Runway designed for MCC standard crane types: TRSGCH, TRSGWR, TRSGWD, or TRSGWS. Special or customer supplied cranes require review of structure for specific crane design
- For non-standard lengths, widths, or heights; use next larger structure and order with exact dimensions required.
- Structure kit includes: ACAD system installation drawing specific for order, all structural steel work per attached concept drawing, bolting hardware, anchoring hardware for 6" minimum floor thickness, and gray primer paint finish.
- Structure deflection is approximately 1/2" maximum in all directions. Please contact MCC if additional deflection control is required.
- Runway rail height "RH" is calculated for each structure for specific crane to be used. Formula: Rail Height RH = Clear Height (CH) - Crane Height (U)-3" clearance
- Minimum 6" reinforced concrete (min.4000psi) floor required for all structures.
- Base runway cell is a braced cell. Additional cells can be unbraced cell. Every other cell must be a braced cell. See "Cell Configuration Diagram" for layout scenarios.

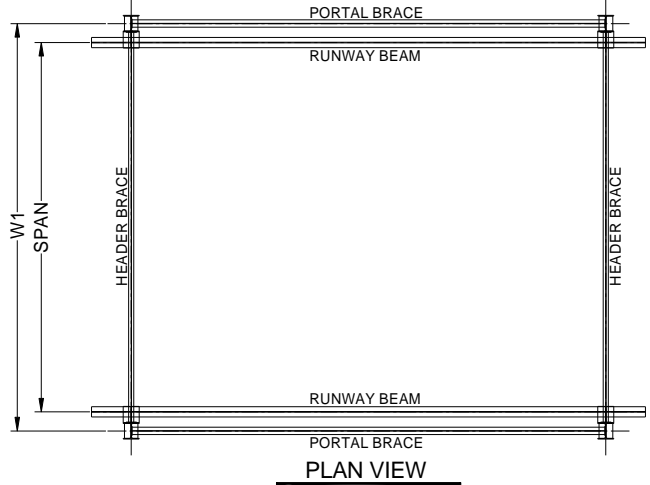

PLAN VIEW

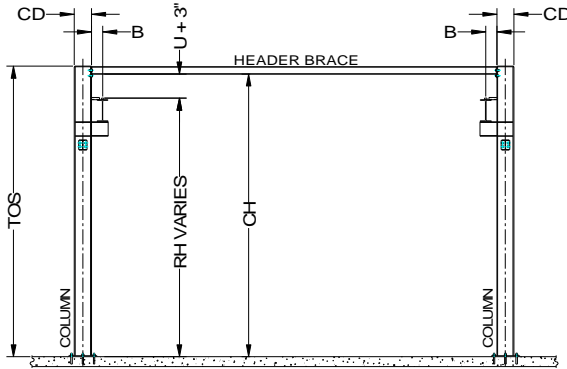

END VIEW

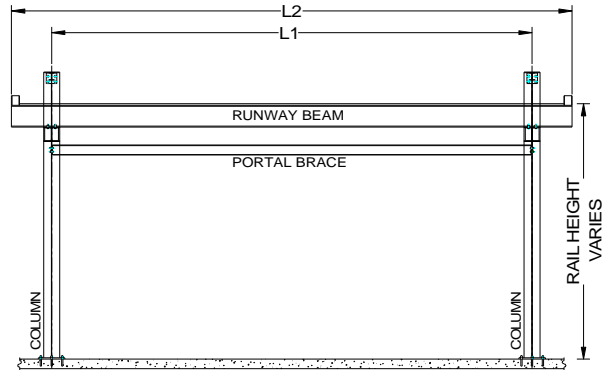

LONGITUDINAL VIEW

5-TON CAPACITY / 25 FT (TOS) SYSTEM HEIGHT

ITEM #	SYSTEM I.D. NUMBER	LENGTH L1 (FT)	WIDTH W1 (FT)	HEIGHT TOS (FT)	HEIGHT CH (FT)	SPAN (FT)	LENGTH L2 (FT)	HEIGHT RH (FT)	WIDTH CD (IN)	WIDTH B (IN)	SYSTEM WT. (LBS)	# COL'S. TOTAL
1	FSTM-10000-20-20-25	20.00	20.00	25.00	24.50	17.50	25.00	CH-U-3"	14.00	8.00	14,275	4
2	FSTM-10000-25-20-25	25.00	20.00	25.00	24.50	17.50	30.00	CH-U-3"	14.00	8.00	15,556	4
3	FSTM-10000-30-20-25	30.00	20.00	25.00	24.50	17.50	35.00	CH-U-3"	14.00	8.00	17,625	4
4	FSTM-10000-20-25-25	20.00	25.00	25.00	24.33	22.50	25.00	CH-U-3"	14.00	8.00	14,558	4
5	FSTM-10000-25-25-25	25.00	25.00	25.00	24.33	22.50	30.00	CH-U-3"	14.00	8.00	15,840	4
6	FSTM-10000-30-25-25	30.00	25.00	25.00	24.33	22.50	35.00	CH-U-3"	14.00	8.00	17,909	4
7	FSTM-10000-20-30-25	20.00	30.00	25.00	24.33	27.50	25.00	CH-U-3"	14.00	8.00	15,094	4
8	FSTM-10000-25-30-25	25.00	30.00	25.00	24.33	27.50	30.00	CH-U-3"	14.00	8.00	16,375	4
9	FSTM-10000-30-30-25	30.00	30.00	25.00	24.33	27.50	35.00	CH-U-3"	14.00	8.00	18,444	4
10	FSTM-10000-20-35-25	20.00	35.00	25.00	24.17	32.50	25.00	CH-U-3"	14.00	8.00	15,388	4
11	FSTM-10000-25-35-25	25.00	35.00	25.00	24.17	32.50	30.00	CH-U-3"	14.00	8.00	16,669	4
12	FSTM-10000-30-35-25	30.00	35.00	25.00	24.17	32.50	35.00	CH-U-3"	14.00	8.00	18,738	4
13	FSTM-10000-20-40-25	20.00	40.00	25.00	24.00	37.50	25.00	CH-U-3"	14.00	8.00	15,955	4
14	FSTM-10000-25-40-25	25.00	40.00	25.00	24.00	37.50	30.00	CH-U-3"	14.00	8.00	17,236	4
15	FSTM-10000-30-40-25	30.00	40.00	25.00	24.00	37.50	35.00	CH-U-3"	14.00	8.00	19,305	4
16	FSTM-10000-20-45-25	20.00	45.00	25.00	23.83	42.50	25.00	CH-U-3"	14.00	8.00	16,606	4
17	FSTM-10000-25-45-25	25.00	45.00	25.00	23.83	42.50	30.00	CH-U-3"	14.00	8.00	17,887	4
18	FSTM-10000-30-45-25	30.00	45.00	25.00	23.83	42.50	35.00	CH-U-3"	14.00	8.00	20,397	4
19	FSTM-10000-20-50-25	20.00	50.00	25.00	23.67	47.50	25.00	CH-U-3"	14.00	8.00	17,551	4
20	FSTM-10000-25-50-25	25.00	50.00	25.00	23.67	47.50	30.00	CH-U-3"	14.00	8.00	18,832	4
21	FSTM-10000-30-50-25	30.00	50.00	25.00	23.67	47.50	35.00	CH-U-3"	14.00	8.00	21,342	4

ADDTL. CELL LENGTH

ADDTL. LGTH (FT)	ADDTL. WT. (LBS)	ADDTL. COL'S. (EA)
20.00	6,225	2
25.00	7,139	2
30.00	8,536	2
20.00	6,367	2
25.00	7,281	2
30.00	8,678	2
20.00	6,634	2
25.00	7,548	2
30.00	8,945	2
20.00	6,319	2
25.00	7,233	2
30.00	8,630	2
20.00	6,603	2
25.00	7,517	2
30.00	8,914	2
20.00	6,928	2
25.00	7,842	2
30.00	9,617	2
20.00	7,401	2
25.00	8,315	2
30.00	10,090	2